

MV- C Trojan



Construction/ Classification

Date Of Build	2025
Category	Bureau Veritas; I+ Hull MACH Anchor handling, Tier III AUT-UMS; DYNAPOS AM/AT
DP System	1x Praxis Mega Guard DP1 system
IMO Number	9988567
Call Sign	
MMSI	
Flag	UK
Port of Registry	Kirkwall

Main Data

Length O.A.	30.17 m
Beam O. A	13.45 m
Beam Moulded	12.50 m
Depth Moulded	3.97 m
Draft	3.0 m
Cargo Deck Area	165 m2
Deck Load	10 t/m2
Gross Tonnage	430 GT

Tank Capabilities

Fuel Oil	100.0 m ³
Fresh Water	56.0 m ³
Dirty Oil	2.0 m ³
Sewage	15.0 m ³
Sludge	4.6 m ³
Hydraulic Oil	2.6 m ³
Lubrication Oil	2.0 m ³
Bilge Water	4.1m3
TW Tanks	49.6m3

Performances

Speed	10.0 kn
Bollard Pull Max.	31T

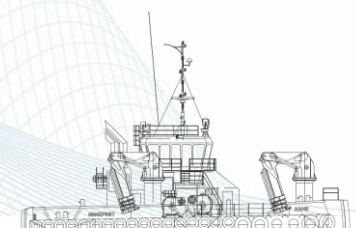

MV- C Trojan

Propulsion System

Main Engines	2x Cat C32 TTA ACERT – B-rating
Total Power	1790 bkW
Gearboxes	2x Reintjes WF 580- 7,526:1 with trolling
Propulsion	2x Promarin fixed pitch propellers
Propeller Diameter	2x 1900 mm in Optima nozzles
Steering Gear	Independent Control
Diameter	2x 1900 mm in Optima nozzles
Bow thruster	Electrical driven, 184 ekW
Stern Thruster	Electrical driven, 147 ekW

Auxiliary Equipment

Generator Sets	4x Caterpillar C7.1, 118 ekW, 50 Hz
Hydraulic Power	Electrical driven power pack with multiple pumps
Transfer Pump Fo/Fw	1x Azcue CA80/20A 50 m ³ /hr @ 4,75 Bar
Fuel Oil Separator	1x Facet, MV-11-AG, 1200 l/hr

Deck Lay-out

Anchor	1x 300kg HHP, 1 stored
Anchor Winch	1x Hydraulically driven, Kraaijeveld KAB-1-H-19D
Deck crane Fore	HS Marine AKC 290 LHE3 11.3T @ 16.5 m, 25.1T @8.28 m
Deck crane Aft	HS Marine AKC 290 LHE3 11.3T @ 16.5 m, 25.1T @8.28 m
Anchor Handling Winch Capacities	1x Kraaijeveld KA-20/2-H-TR Pull 100T @ 4.1m/min, BHL=150T @first Layer Wire Cap. 650 m of Ø 44 mm
Towing Winch	1x Kraaijeveld KAS-20-H-TR Pull 50 t @ 10 m/min, BHL = 100 ton @ first layer Wire capacity 650 m of Ø 36 mm
Towing Pins Front	1x DMC double pin with chain stopper
Tugger winch	4x Kraaijeveld SA-10-H-TR, 20-ton pull, 220 mtr dia 54 mm rope

Features

Comfortable heated and air-conditioned accommodation for 18 persons in total. The accommodation for 5 crew in deckhouse is according to MLC regulations and divided in one double crew cabins and three single officer cabins.

Below the main deck five cabins are provided for 8+2 passengers. A combined galley and mess, sanitary facilities and stores are provided.

The technical space is fitted below wheelhouse. Office and small change room is facilitated at main deck level. A deck store with entrance from main deck is placed in front of the superstructure.

Nautical And Communication Equipment

Search Lights	2x Pesch, 2000 W
Radar System	1x Furuno, FAR-1518BB
Compass	1x Cassens & Plat, Reflecta 1
Gyro Compass	1x Simrad, GC-80
Autopilot	1x Simrad, AP-70
GPS	1x Furuno, GP-170D
Echosounder	1x Furuno, FE-800
Speed log	1x Skipper, EML-224
AIS	1x Furuno, FA-170
Intercom	1x Phonetech, CIS3101
VHF	2x Cobham, CIS3101
Handheld VHF	2x Entel, HT649
SSB	1x Cobham, Sailor 6310
Inmarsat- C	2x Cobham, Sailor 6110
Navtex	1x Furuno, NX-700B
Watch Alarm	1x Marble MS421B
Entertainment System	1x Seas Systems, SEAS-6000

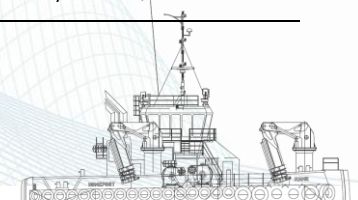

MV- C Trojan

General Arrangement

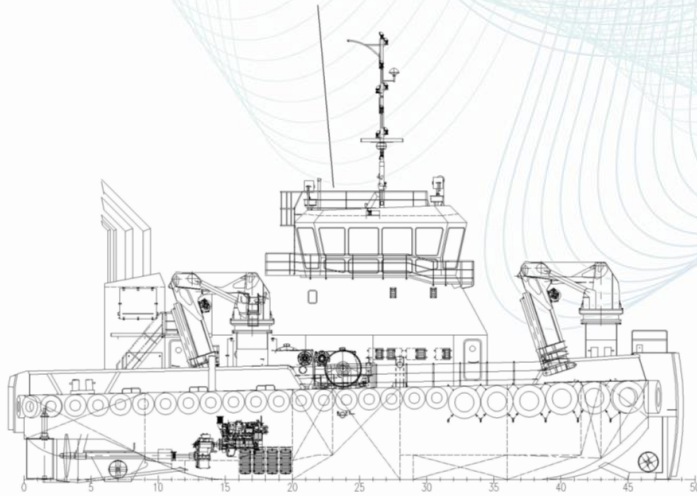

Tween Deck

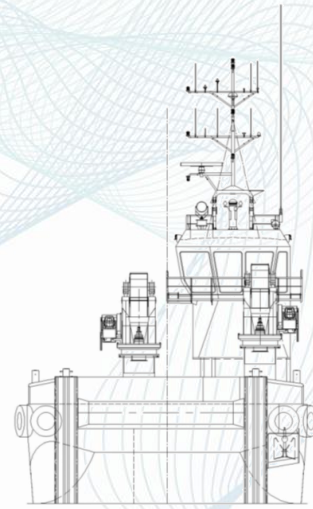

Top Deck

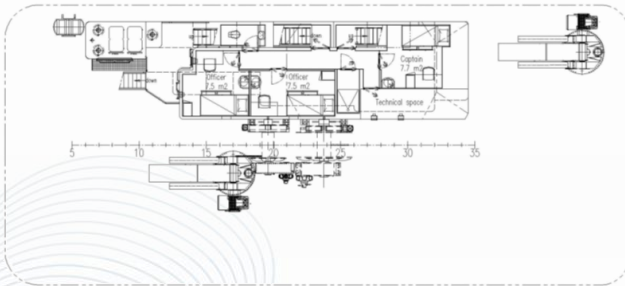

Main Deck

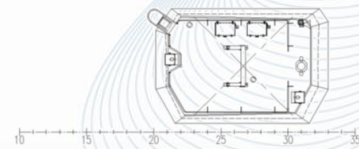

Wheelhouse Deck

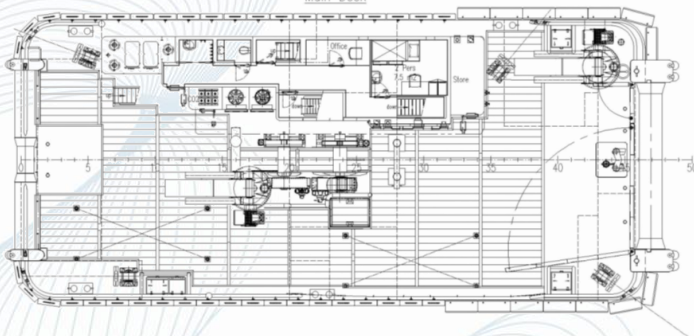

Below Main Deck

